

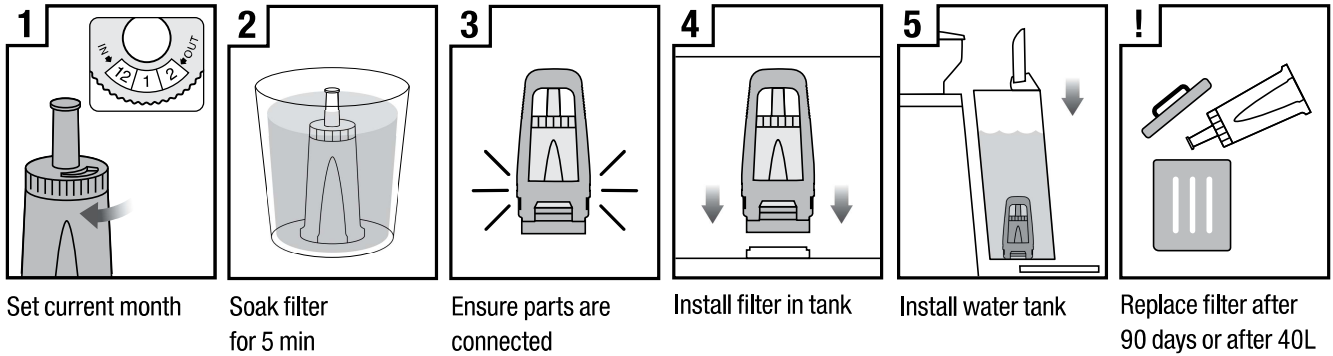

Care & Cleaning

REPLACING THE WATER FILTER



The provided water filter helps reduce the risk of scale build-up in and on many of the inner functioning components. Replacing the water filter after three months or 40L will reduce the need to descale the machine.

The limitation of 40L is based on water hardness level 4. If you are in level 2 area, you can increase this to 60L.

CLEANING CYCLE

The CLEAN ME light will illuminate when a cleaning cycle is required. This is a back-flushing cycle and is separate from descaling.

1. Insert the 1 CUP filter basket into the portafilter, followed by the supplied cleaning disc, followed by 1 cleaning tablet.
2. Lock the portafilter into the group head and place a large container beneath the portafilter spouts.
3. Ensure the water tank is filled with cold water and the drip tray is empty.
4. Press the POWER button to switch the machine off.
5. Press the 1 CUP and 2 CUP buttons simultaneously, then also press the POWER button. Hold all 3 buttons together for approximately 10 seconds.
6. The cleaning cycle will commence and last for approximately 5 minutes. During this time, water will intermittently flush into the portafilter to dissolve the cleaning tablet and flush back into the group head. If your cleaning disc is without a hole in the middle, hardly any or no water should come through the portafilter.

7. Remove the portafilter and ensure the tablet has completely dissolved. If the tablet has not dissolved; repeat from step 4 of the cleaning cycle until the tablet is dissolved.
8. Once the tablet has completely dissolved, remove the cleaning disc, reinsert the portafilter and press the 2 CUP button to rinse the brew head from cleaning solution. We recommend to use a cup as well, to avoid water splashing onto the machine. Once complete, make sure to wipe off any splashes with a soft dry cloth.

DESCALING

After regular use, hard water can cause mineral build up in and on many of the inner functioning components, reducing the brewing flow, brewing temperature, power of the machine, and taste of the espresso.

It is recommended to descale your unit every 90 days when water hardness is at level 4; and when water hardness is at level 6, descale your unit every 60 days.



WARNING

Do not immerse power cord, power plug or appliance in water or any other liquid. The water tank should never be removed or completely emptied during descaling.